

PVC O+S BALCONY PROFILE WITH MESH

Product description:

Top quality profile. The PVC used for production contains special additives which make it resistant to UV radiation. The glass mesh used has a weight of min. 145g comes from renowned European producers. The protective tape protects the edge of the drip cap against dirt and makes it easier to complete the work without the need for additional cleaning of the drip cap.

The mesh is connected to the profile with a PVC strip. The connection occurs as a result of the co-extrusion process. Thanks to this method, the connection between the mesh and the profile is completely resistant to weather conditions and it is impossible to separate the mesh from the profile without destroying it.

**Many manufacturers use PVC mixtures of unknown composition, not resistant to long-term exposure to UV rays.
Use original JS Technologie profiles - resistant to UV radiation!

Material:

PVC (PVC, polyvinyl chloride) - a synthetic polymer used to produce plastics. It is characterized by flexibility and mechanical strength. Chemically and weather-resistant.

Glass mesh - made of glass fibers properly braided at right angles. It is a specially dedicated product for the construction industry.

Technical sketch:

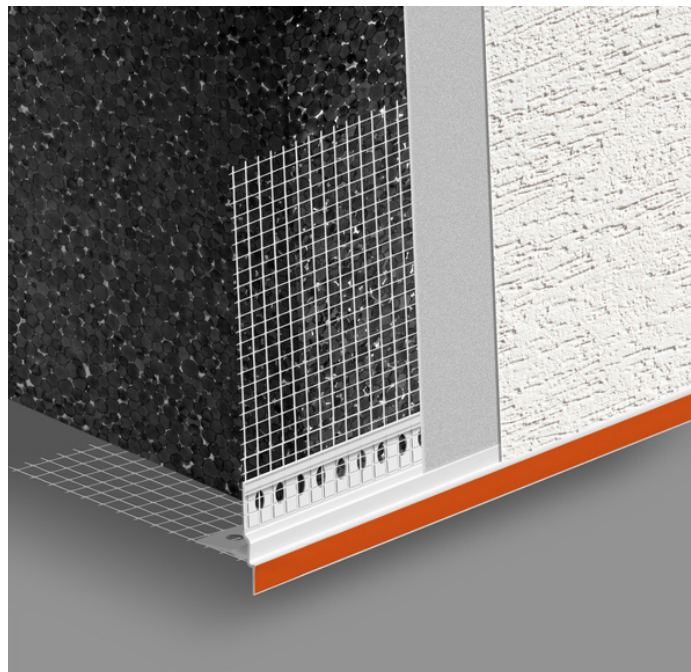
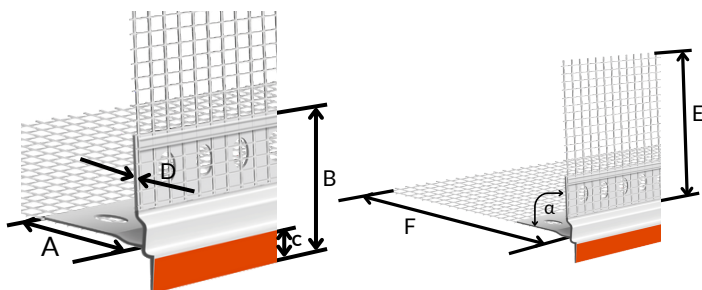

Functional graphics for product PVC O+S.

Intended use:

The strips are designed to drain water from the facade in places exposed to capillary water seepage, such as balconies, cornices and other elements protruding beyond the building outline in thermal insulation systems (ETICS). They extend the life of the plaster and improve the aesthetics of the facade.

Application:

The profile is installed on the outer part of the facade. Drip cap with mesh is used in horizontal elements requiring water drainage, e.g. balconies, terraces, cornices, etc. The profile should be installed on the horizontal edge of the facade using Styrofoam glue, pulling the mesh surface. Then apply structural plaster according to the technology and remove the protective tape to obtain a clean eaves edge.

| symbol | PVC O+S |
|-------------------------|--|
| material | PVC |
| dimension A | 23 mm |
| dimension B | 33 mm |
| angle α | 88° |
| dimension C | 8,5 mm |
| dimension D | 1 mm |
| dimension E | 100 mm |
| dimension F | 100 mm |
| mesh grammage | 145 g or other at the customer's request |
| tape color | blue orange |
| weight per linear meter | 122 g |
| package (pcs) | 25 |
| wooden box (pcs) | 1 375 |
| pallet (pcs) | 2 750 |

Released on February 15, 2024.

This update invalidates all previous versions of this data sheet. Product dimensions and weights quoted are nominal and may be within permitted manufacturing tolerances.